



newblinds.co.uk

## Wooden Blinds | Faux Wood Blinds – Installation Instructions

### HOW TO INSTALL BLIND

(Read Child Safety information first)

Select mounting position to suit:

Inside Mounting:

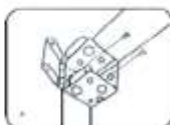

Outside Mounting:

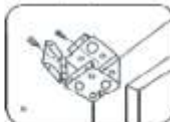

Top / Ceiling Mounting:



- 1) Measure where the blind is to hang.
- 2) Ensure it is centred & level.
- 3) Pencil mark each side of blind as fixing points of brackets.
- 4) Hold bracket in position, door open - mark fix points.  
Repeat for both.
- 5) Insert & tighten screws through slots.
- 6) Check correctly positioned.
- 7) Slide headrail into brackets - cords out.
- 8) Close bracket doors securely - locked.

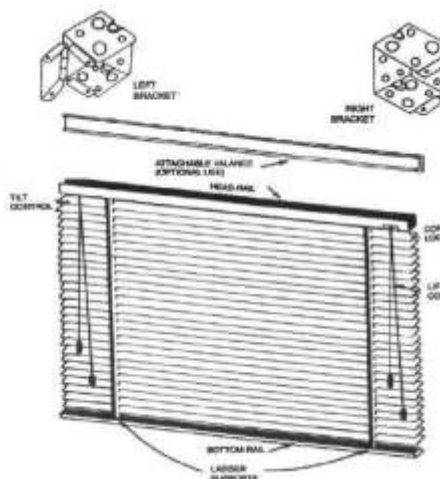

### BLIND FITTING HEIGHT

Child Safety Legislation dictates that the headrail of this should NOT be fitted lower than 1.5 metres (approx. 60" floor level).

**D.I.Y OR PROFESSIONAL INSTALLATION CHILD SAFETY CORD CLEAT MUST BE FITTED!**

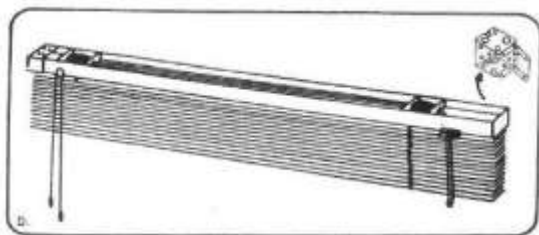

Attach a minimum of 2 plastic clips over the edge of the headrail & engage. DO NOT FIT VALANCE until blind is safely in place. Fit valance into clips.

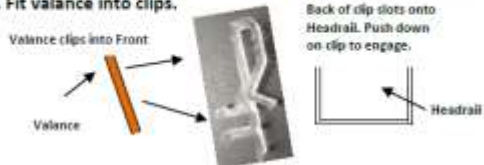

Correctly installed at 1.5m (60") from the floor, this supplied non-integral Child Safety Device is screw fixed & stores excess cord out of a child's reach.

### CHILD SAFETY BREAKAWAY DEVICE

A Cord Consolidator is fitted to this blind. It's purpose is to reduce the possibility of a hazardous cord loop forming. It will break apart if undue pressure is applied, but after inspection, can be reconnected again. DO NOT MODIFY this device to stop its break apart capability.



Newblinds.co.uk Limited, Unit 8 Chichester Road, Romiley, SK6 4BL  
T 0800 169 3765 E customer.services@newblinds.co.uk W newblinds.co.uk

Registered Office as above. Registered in England & Wales No: 06872821.



newblinds.co.uk

**OPERATING (Please read carefully the Child Safety advice on labels attached to your Blind)**

- 1) Stop rings on cords prevent pull-through and **MUST NOT** be disconnected or removed.
- 2) Break-apart Child Safety Joining device on cords **MUST NOT** be removed.
- 3) BSEN13120 requires Cord Cleat(s) at 1.5m height. These **MUST** be installed.
- 4) **LEFT SIDE CORDS** of an SLX blind rotate the slats
- 5) **RIGHT SIDE CORD(S)** of an SLX Blind raise / lower.  
(Combined into 1 for Cord Consolidator for safety reasons)
- 6) Pull to raise & lock mechanism in headrail will keep b up when carefully released.
- 7) Support the weight of the blind whilst raising.
- 8) Lower Blind by holding **RIGHT** cord(s) & gently release lock mechanism. **ALWAYS** support the weight of the l it lowers. **DO NOT** let blind fall under its own weight.

**MAINTENANCE**

SLX real wood venetian blinds are designed to last a long time if proper care is taken of them and do not need much effort to m

Regular cleaning will help the visual quality remain the same but in high sun positions some fading is possible.

Operating cords and internal operating mechanisms are best maintained professionally. Contact installer for such maintenance

Use an ostrich feather duster regularly to remove light dust & any other loose bits that may be on the slats. To give a final thoro use a slightly dampened cloth to wipe slats.

**DO NOT** use soap & water to clean SLX real wood venetian blinds in case water seeps into the slats, which will cause warpage.

The location of the window can affect whether an SLX real wood venetian is appropriate or not. This is a natural product & high direct sunlight may magnify the heat impact on the slats, rapidly drying them out & encouraging warping. Humidity is never goc wood, so bear this is mind if choosing to site them in kitchens or conservatories subject to wide temperature variations.

---

Newblinds.co.uk Limited, Unit 8 Chichester Road, Romiley, SK6 4BL  
T 0800 169 3765 E [customer.services@newblinds.co.uk](mailto:customer.services@newblinds.co.uk) W [newblinds.co.uk](http://newblinds.co.uk)

Registered Office as above. Registered in England & Wales No: 06872821.



newblinds.co.uk

PLEASE KEEP BABY'S COT OR CHILD'S BED AWAY FROM WINDOWS AND ENSURE THAT ALL BLIND & CORDS ARE KEPT OUT OF REACH.

**WARNING**

Young children can be strangled by loops in pull cords, chains, tapes and wires cords that operate the product.



To avoid strangulation and entanglement, keep cords out of the reach of young children. Cords may become wrapped around a child's neck.

Move beds, cots and furniture away from window covering cords.

Do not tie cords together. Make sure cords do not twist and create a loop.

Children can strangle if this safety device is not installed. Always use this device to keep cords or chains out of reach of children.

**CHILD SAFETY**

Child Safety Devices are fitted to this blind or are supplied as non-integral components. This is required to comply with BS EN 13120.

Please ensure your blind installer explains the requirements to your satisfaction and is able to install all non-integral safety items or if you are fitting this blind yourself, that you understand and are able to do so.

Information about blinds and Child Safety can be found at [www.bbsa.org.uk](http://www.bbsa.org.uk) & at [www.makeitsafe.org.uk](http://www.makeitsafe.org.uk)



This label accompanies a non-integral safety device (cleat) designed to wrap excess cord around away from a child's reach at a height of 1.5m (approx.) from floor level.