



newblinds.co.uk

Solar Film Blinds

Installation Guide

FRAGILE-HANDLE WITH CARE

THE FILM WHICH FORMS THE SCREENS IS VERY FRAGILE AND THE UTMOST CARE SHOULD BE TAKEN WHEN FITTING THE SCREENS TO ENSURE THE FILM/FABRIC IS NOT DAMAGED. SHOULD YOU NEED TO HANDLE THE FILM/FABRIC PLEASE USE THE COTTON GLOVES PROVIDED.

Tools Required

Tape measure, Pencil, Drill, Drill bits (2.5mm/3.3mm), PZ1 Screwdriver, PZ2 Screwdriver, Spirit Level

Bracket Positions

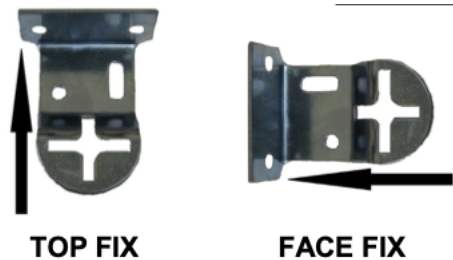

Brackets can either be top fixed into the ceiling of the window recess or face fixed around the recess as shown above.

Each blind will have two brackets:

- (1) The bracket for the chain operating mechanism.
- (2) The bracket for the idle end.

The bracket for the operating mechanism should be positioned on the side on which you have specified you would like the chain to be positioned. Brackets can be fixed to any flat surface above, behind or to the side of the blind.

Mark with a pencil the position of the brackets and screw holes. To calculate the spacing between the brackets add 39 mm to the width of the blind fabric. This takes into account the bracket and bracket covers.

When considering where to position the brackets, also check that you are leaving enough clearance so that the rolled-up fabric will not touch any of the surrounding surfaces.

We suggest marking the outside of bracket positions (including bracket covers) on the fixing surface. Then offer up the brackets to the fixing surface and mark the screw positions. Then drill and plug the screw holes, before fixing your brackets in place with screws.



newblinds.co.uk

We would suggest using a spirit level to ensure that your brackets are level. Fixing one bracket higher than the other will cause the roller blind fabric to run-off which may cause fraying and damage of the fabric. If necessary, use packers to ensure that brackets are fixed level.

Hang the Blind in Brackets

Now that the brackets are in position, offer the blind up to the brackets with the fabric hanging from the back of the roller tube (if you have selected standard roll) or the front of the tube (if you have selected reverse roll).

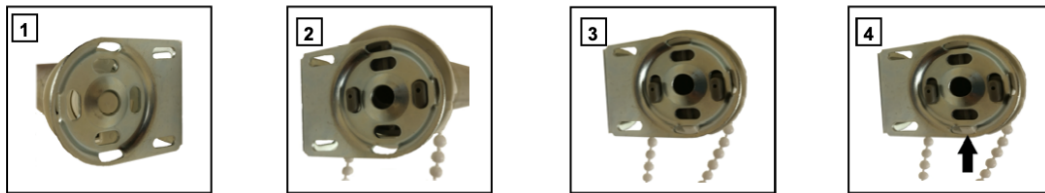

- 1: Locate the Pin End in to position.
- 2: Locate the Clutch into the bracket.
- 3: Lower the Clutch hooks into the bracket until the Clutch clicks into position.
- 4: To remove the Roller Screen/Blind. You must first release the Clutch by pressing the white lip shown. (Damage may occur if this button is not pressed when removing the Clutch).

Child Safety - Child Safety Chain Connectors

Solar Film blinds are usually supplied with plastic chain. The chain will be fitted with child safety chain connectors. Two connectors will be fitted to the operating chain 200mm apart. If excessive load is applied to the looped chain, then one of the connectors will break apart. Before re-connecting the connector, please check it for damage. If the connector is damaged please contact us for a replacement.

NOTE TO INSTALLER:

Please ensure a general child safety warning tag remains fitted to the chain after installation.

We recommend leaving a copy of these instructions with the user and obtaining signed acknowledgement that they have received the instructions and that the blind operation and safety devices have been explained/demonstrated to them.



OPERATING THE BLIND

Chain operated roller blinds are raised and lowered as follows, by pulling smoothly and steadily:

	Standard Roll	Reverse Roll
Pulling Back Chain	Moves Blind Down	Moves Blind Up
Pulling Front Chain	Moves Blind Up	Moves Blind Down

CHILD SAFETY - BS EN 13120 GUIDELINES FOR ROLLER BLINDS

	Child Safety Chain Connectors
Fixing Height Known	Chain length must terminate more than 0.6m from floor level. Chain must be fitted with 2 child safety connectors 200mm apart
Fixing Height Unknown - Blind drop greater than 2.5m	Chain length must be no greater than 2/3 of blind drop. Chain must be fitted with 2 child safety connectors 200mm apart
Fixing Height Unknown - Blind drop less than 2.5m	Chain length must be no greater than 2/3 of blind drop. Chain must be fitted with 2 child safety connectors 200mm apart

NOTE TO INSTALLER:

Please ensure a general child safety warning tag remains fitted to the chain after installation. We recommend leaving a copy of these instructions with the user and obtaining signed acknowledgement that they have received the instructions and that the blind operation and safety devices have been explained/demonstrated to them.

WARNING!

Young children can be strangled by loops in pull cords, chains, tapes and inner cords that operate the product.
To avoid strangulation and entanglement, keep cords out of the reach of young children.
Cords may become wrapped around a child's neck.
Move beds, cots and furniture away from window covering cords.
Do not tie cords together.
Make sure cords do not twist and create a loop.